

PANASONIC

TAPE RECORDER SERVICE MANUAL

MODEL RQ-706S

— TENTATIVE MANUAL —

MATSUSHITA ELECTRIC INDUSTRIAL CO., LTD.

Kadema, Osaka, Japan

Price of Manual \$1.00

MATSUSHITA ELECTRIC CORPORATION OF AMERICA

(U.S.A.) Pan-American Building, 200 Park Avenue,
New York N.Y. 10017.

SPECIFICATIONS

Power Source:	AC 117 volts 60 cps
Power Consumption:	Approx. 45W
Power Output:	4W max.
Transistor:	2SB 345(1) 2SB 175(3) 2SB 324(3)
Diode:	OA 70(3)
Recording System:	AC bias 50 Kc
Erasure System:	AC erase
Reel Size:	7" max.
Monitor System:	Sound monitor
Track System:	2 track system
Tape Speed:	3 speeds, 7-1/2, 3-3/4 and 1-7/8 ips
Frequency Response:	50 ~ 15,000 cps at 7-1/2 ips 50 ~ 8,000 cps at 3-3/4 ips 50 ~ 4,000 cps at 1-7/8 ips
Input:	"Mic" input 4.7 K Ω (2) "AUX" input 100 K Ω (1)
Output:	"EXT.SP" output 8 Ω (1)
Program Time:	6 hours for 7" 150% tape at 1-7/8 ips
Recording Level Indicator:	VU meter
Built-in Speaker:	6" x 4" Parmanent dynamic speaker
Dimensions:	Approx. 14-3/4"(W) x 6-1/4"(D) x 11-1/4"(H)
Weight:	Approx. 17-1/2 lb

PARTS LOCATION

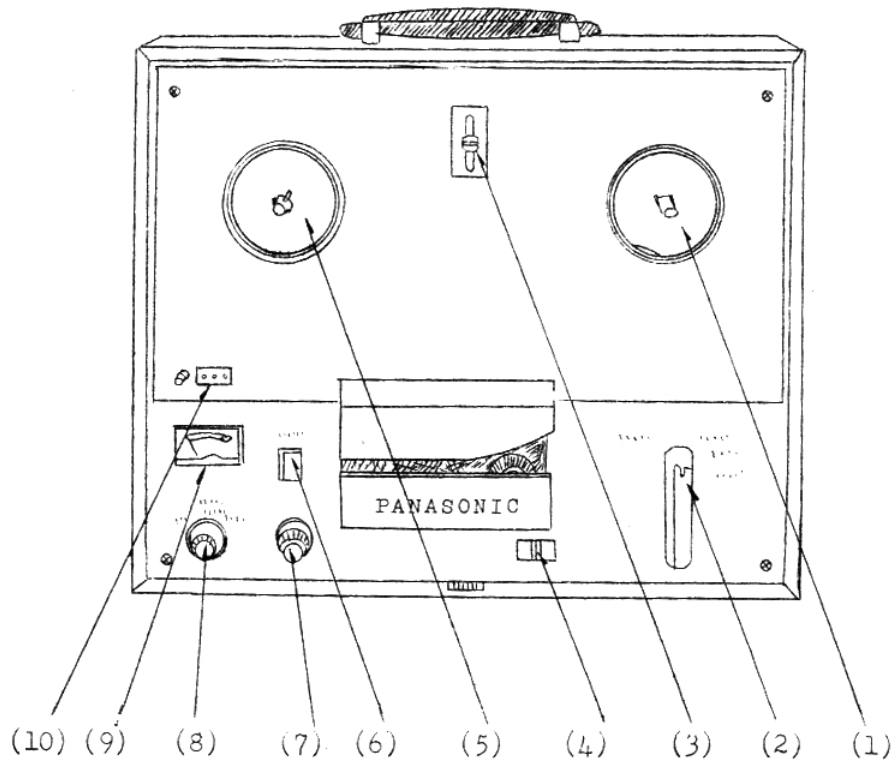

- (1) Takeup Reel Table
- (2) Function Lever
- (3) Speed Selector Knob
- (4) Easy-matic Switch
- (5) Supply Reel Table
- (6) Record Button
- (7) Volume Control and Power ON/OFF Switch
- (8) Mood Selector Knob
- (9) VU Meter
- (10) Tape Counter

DISASSEMBLY INSTRUCTION

HOW TO REMOVE THE PANEL

1. Remove the Volume Control Knob (A), Mood Selector Knob (B), Speed Selector Knob (C) and Head Cover (D). Loosen the Function Lever Setscrew, and remove the Function Lever Knob (E).
2. Remove 4 screws (F) in the 4 corners of the panel, and a screw (G) under the Head Cover.
3. Remove the Panel.

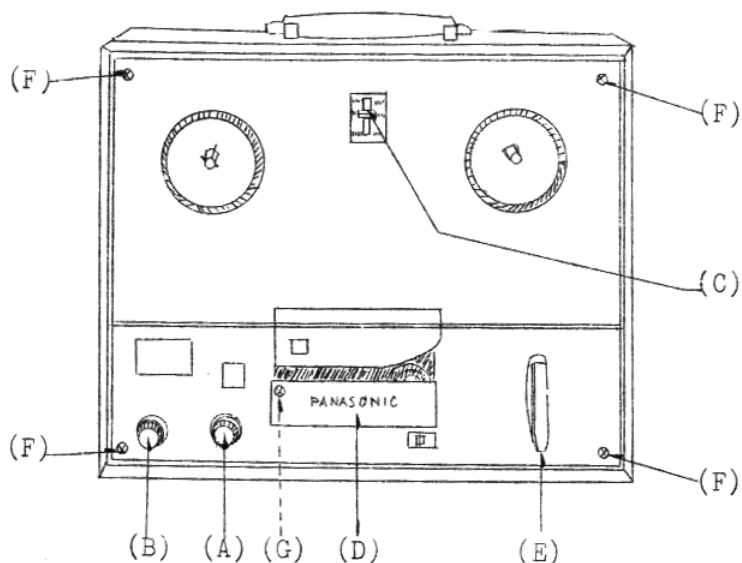

HOW TO REMOVE THE CHASSIS

1. Remove the Panel.
2. Turn the set upside down, and remove 4 Rubber Feet (H).
3. Lift up the Body Case.

At this time care must be taken, because the lead wire is connected to both side speakers.

This lead wire of the speaker can be removed.

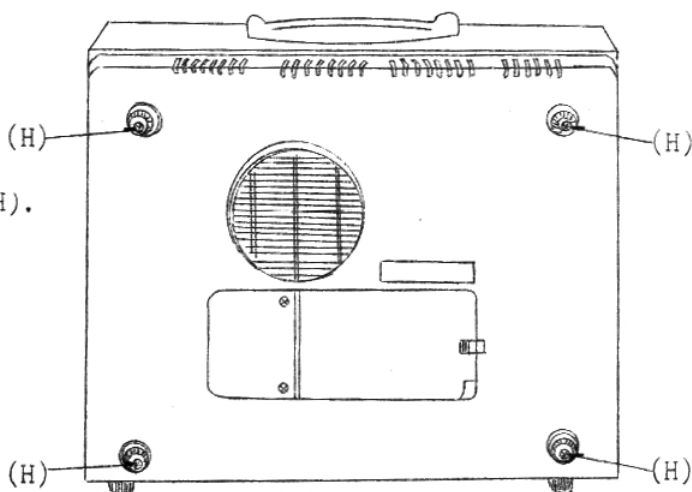

PARTS LIST FOR IDENTIFICATION WITH EXPLODED VIEW

ATTENTION: This parts list is to identify each part of the exploded view.

When you place an order for replacement parts, please refer to the replacement parts list we sent you.

Please note that * mark is put before Ref. No. of each parts which we handle as replacement parts.

RESISTORS

* R1, 17, 21	Carbon Resistor	4.7KΩ	1/4W	ERD-14TK472
* R2	Carbon Resistor	100KΩ	1/4W	ERD-14TK104
* R3	Carbon Resistor	330Ω	1/4W	ERD-14TK331
* R4	Carbon Resistor	5.6KΩ	1/4W	ERD-14TK562
* R5	Carbon Resistor	10KΩ	1/4W	ERD-14TK103
* R6	Carbon Resistor	10KΩ	1/4W	ERD-14VK103
* R7, 35	Carbon Resistor	2.2KΩ	1/4W	ERD-14TK222
* R8, 9	Carbon Resistor	3.9KΩ	1/4W	ERD-14VK392
* R10	Carbon Resistor	6.8KΩ	1/4W	ERD-14VK682
* R11	Carbon Resistor	18KΩ	1/4W	ERD-14VK183
* R12	Carbon Resistor	33KΩ	1/4W	ERD-14TK333
* R13	Carbon Resistor	220KΩ	1/4W	ERD-14VK224
* R14	Carbon Resistor	8.2KΩ	1/4W	ERD-14VK822
* R15	Carbon Resistor	390Ω	1/4W	ERD-14TK391
* R16	Carbon Resistor	2.7KΩ	1/4W	ERD-14VK272
* R18, 29, 33	Carbon Resistor	1.8KΩ	1/4W	ERD-14VK182
* R19	Carbon Resistor	27KΩ	1/4W	ERD-14VK273
* R20, 26	Carbon Resistor	4.7KΩ	1/4W	ERD-14VK472
* R22	Carbon Resistor	3.3KΩ	1/4W	ERD-14VK332
* R23	Carbon Resistor	1KΩ	1/4W	ERD-14VK102
* R24	Carbon Resistor	180Ω	1/4W	ERD-14VK181
* R25	Carbon Resistor	47KΩ	1/4W	ERD-14TK473
R27	-	-	-	-
* R28	Carbon Resistor	18KΩ	1/4W	ERD-14TK183
* R30	Carbon Resistor	220Ω	1/4W	ERD-14VK221
* R31	Carbon Resistor	56Ω	1/4W	ERD-14VK560
R32	-	-	-	-
* R34	Carbon Resistor	680Ω	1/4W	ERD-14VK681
* R36, 38	Carbon Resistor	68Ω	1/4W	ERD-14VK680
* R37	Carbon Resistor	2.2KΩ	1/4W	ERD-14VK222

* R39, 40	Wire Wound Resistor	1.5Ω	1/2W	ERW-12L1R5
R41	-	-	-	-
* R42, 43	Solid Resistor	10Ω	1/2W	ERC-12GM100
* R44	Carbon Resistor	270KΩ	1/4W	ERD-14VK224
* R45	Carbon Resistor	56KΩ	1/4W	ERD-14VK563
* R46	Carbon Resistor	33Ω	1/4W	ERD-14TK330
* R47	Carbon Resistor	150Ω	1/4W	ERD-14TK151
* R48	Solid Resistor	1.2KΩ	1/2W	ERC-12GM101
* R49	Carbon Resistor	120Ω	1/4W	ERD-14VK121
* R50	Solid Resistor	150Ω	1W	ERC-1GK121
* R51	Carbon Resistor	470Ω	2W	QRD-2PZK471
* R52	Carbon Resistor	10Ω	1/4W	ERD-14VK100
* R53	Solid Resistor	100Ω	1/2W	ERC-12GM101
* R54	Carbon Resistor	1KΩ	1/4W	ERD-14VK102
(apporopriable)	Carbon Resistor	680Ω	1/4W	ERD-14VK681
	Carbon Resistor	1.5KΩ	1/4W	ERD-14VK152

VARIABLE RESISTOR

* VR1	Variable Resistor	5KΩ-A	EVC-BO1L20A53
-------	-------------------	-------	---------------

CAPACITORS

* C1, 8	Electrolytic Capacitor	3μF	ECE-B15V3
* C2	Electrolytic Capacitor	10μF	ECE-A6V10
* C3, 11, 15	Electrolytic Capacitor	30μF	ECE-A6V30
* C4	Mylar Capacitor	0.001μF	ECQ-MO5102MZ
* C5	Polyasylene Capacitor	120PF	ECQ-SO2121KZ
* C6	Mylar Capacitor	0.022μF	ECQ-MO5223KZ
* C7	Mylar Capacitor	0.1μF	ECQ-MO5104KZ
* C9	Electrolytic Capacitor	200μF	ECE-A10V200
* C10	Electrolytic Capacitor	500μF	ECE-A10V500
* C12, 29	Electrolytic Capacitor	50μF	ECE-A15V50
* C13, 14, 16, 18	Electrolytic Capacitor	3μF	ECE-A15V3
C17	-	-	-
* C19, 35	Mylar Capacitor	0.022μF	ECQ-MO5223MZ
* C20	Electrolytic Capacitor	100μF	ECE-A3V100
* C21	Mylar Capacitor	0.033μF	ECQ-MO5333MZ
* C22	Electrolytic Capacitor	100μF	ECE-A25V100
* C23, 24	Mylar Capacitor	0.0047μF	ECQ-MO5472MZ
* C25	Electrolytic Capacitor	500μF	ECE-A15V500

* C26, 36	Mylar Capacitor	0.0018 μ F	ECQ-MO5182MZ
* C27	Polystyrene Capacitor	150PF	ECQ-S1151KZ
* C28	Polystyrene Capacitor	180PF	ECQ-S1181KZ
* C30	Electrolytic Capacitor	4 μ F	ECE-A15V41
* C31	Mylar Capacitor	0.1 μ F	ECQ-MO5104MZ
* C32	Polystyrene Capacitor	15000PF	ECQ-S1153KZ
* C33	Electrolytic Capacitor	1000 μ F	ECE-B35V1000
* C34	Trimmer Capacitor		QCV-1010
* C37	Electrolytic Capacitor	0.5 μ F	ECE-A15VOR5M

TRANSISTORS

* Tr1	Transistor	2SB 345
* Tr2, 3, 4	Transistor	2SB 175(A)
* Tr5, 6	Transistor	2SB 324(M,N)
* Tr7	Transistor	2SB 324(J,K,L)

DIODE AND RECTIFIER

* D1, 2, 3	Diode	OA-70
* D4	Selenium Rectifier	16C-4F

THERMISTOR

* SM1, 2	Thermistor	QVM-300A
----------	------------	----------

SWITCHES

* S1	Record/Playback Selector Switch	QSS-1015
* S2	Speed Selector Switch	QSS-1032
* S3	Non Error Switch	QSS-1017
* S4	Stop Switch (A)	QSB-0145
* S5	Stop Switch (B)	QSB-0145
* S6	Mood Selector Switch	ESR-EL23L20A

TRANSFORMERS

* T1	Input Transformer	QLA-0117
* T2	Output Transformer	QLA-0333
* T3	Oscillator Transformer	QLB-0123
* T4	Power Transformer	QLP-0377

ELECTRICAL PARTS

* 201	Record/Playback Head	WY-024Z
-------	----------------------	---------

* 202	Erase Head	WY-212Y
* 203	VU Meter	QSL-0029
* 204	Speaker	EAS-15D281S
* 205	Circuit Board Assembly	-
* 206	Miniature Jack (M3-A)	QJA-102
207	Heat Sink	QTH-1023
* 208	AC Power Cord	QFC-1016A
209	Volume Cover Assembly	QEE-1023
* 210	Pilot Lamp	QVL-101
* 211	Pilot Lamp Socket	QJS-101
212	Wire Crimper	QTD-1139
213	Wire Crimper-A	QTD-1002
214	Wire Crimper-D	QTD-1005
215	HEYCO Bushing	QTD-1129
216	Wire Crimper	QTD-1111
217	Wire Spring	QTD-1121
218	Lug Plate 1-3PRH(4)	QJT-3006-1
219	Insert Terminal-C	QJT-0016
220	Head Shield Cover	QTS-1057
221	Jack Holding Plate-A	QKT-1190
* 222	Jack Holding Plate	QGJ-1078
223	Record Synchronizer-(1)	QML-1298
224	Record Synchronizer-(2)	QML-1299
225	Spring Hold for Record Synchronizer	QMQ-1055
226	Record Synchronizer Spring	QBT-1196
227	Recording Lever Guide	QMP-1101
228	Record Synchronizer Lever Plate Spring	QBP-1095
229	Recording Lever Angle	QMA-1139
230	Circuit Board Angle -(A)	QTT-1306
231	Circuit Board Angle -(B)	QTT-1307
232	Heat Sink Holder	QMH-1047
233	Heat Sink Angle	QTT-1230-2
234	Volume Angle Assembly	-
235	Monitor Switch Angle	QTT-1310
236	Angle for Cord Bushing	QTT-1314
237	Stop Switch Angle	QMA-1154
238	Selenium Rectifier Holding Angle	QTT-1344

MECHANICAL PARTS

1	Screw, +M2.6 ϕ ×16	QHM-226×16C1
2	Limmiter Washer	QAG-1107
3	Tape Limmiter	QWQ-1080
4	Tape Retainer	QMF-1148
5	Tape Guide Pole	QAG-1097
6	Screw, -M2 ϕ ×5	QHM-120×5U3
7	Spring Washer SW2 ϕ	QWS-202U3
8	Screw, -M2 ϕ ×12	QHM-120×12U3
9	Head Adjusting Spring	QBC-1035
10	Screw, -M2 ϕ ×8	QHM-120×8U3
11	Head Holding Plate	QMF-1146
12	Erase Pad Plate	QAP-1112
13	Erase Pad Shaft	QAP-1015
※ 14	Erase Pad Felt	QAP-1016
15	Record/Playback Pad Spring	QAP-1018
※ 16	Record/Playback Pad Plate Assembly	-
17	Record/Playback Pad Shaft	QAP-1014
※ 18	Record/Playback Pad Felt	QAP-1016
19	Screw, +PH3 ϕ ×6	QHN-230×6U3
20	Spring Washer SW3 ϕ	QWS-302U3
※ 21	Tape Limmiter Assembly	-
※ 22	Capstan Holding Screw	QHQ-1006
※ 23	50 cycle Capstan Sleeve	QMS-1226
24	Pipe for Capstan Pole	QBJ-1092
25	Rubber for Base Plate Hold	QBG-1064
26	Tape Shifter	QAS-1029
27	Lock Washer L3 ϕ	QWG-302U3
28	Screw, +PH3 ϕ ×6	QHN-230×6U3
29	Stop Ring E5 ϕ	QNS-504T3
30	Fiber Washer 6.2×11×0.5	QBK-7003
31	Pressure Roller Felt	QBF-1022
32	Pressure Roller	QDP-1129
33	Fiber Washer 6.2×8.2×0.25	QBK-7046
34	Stop Ring E7 ϕ	QNS-704T3
35	Capstan Oil Cap	QDH-1005
36	Felt for Capstan Metal	QBF-1057
37	Screw, +PH4 ϕ ×8	QHN-240×8U3

38	Spring Washer SW4ø	QWS-402U3
39	Wire Cramper-D	QTD-1005
40	Record Lock Spring	QBT-1187
41	Upper Base Plate Assembly	-
42	Flywheel Metal	QMM-1114
43	Holding Metal for Reel Table Bearing	QMH-1046
44	Screw, +PH3øx6	QHN-230x6U3
* 45	Supply Reel Table Assembly	QXP-0152
45-1	Reel Table Felt	QBF-1093
45-2	Reel Pulley Friction Spring	QBC-1061
45-3	Fiber Washer 6.2x11x0.5	QBK-7003
45-4	Stop Ring E5ø	QNS-504T3
45-5	Supply Reel Table	-
45-6	Supply Reel Pulley	-
46	Supply Reel Table Angle	QMA-1130
47	Screw, +PH3øx6	QHN-230x6U3
48	Spring Washer SW3ø	QWS-302U3
49	Reel Table Shaft Retainer	QMM-1020
50	Holding Metal for Reel Table Bearing	QMH-1046
51	Screw, +PH3øx6	QHN-230x6U3
52	Fiber Washer 6.2x8.2x1	QBK-7014
53	Reel Table Counter Pulley	QDP-1128
54	Screw, -PH3øx8	QHN-130x8U3
* 55	Counter Belt	QDB-0061
* 56	Counter	QDC-0017
57	Counter Angle	QMA-1128
58	Spring Washer SW3ø	QWS-302U3
59	Screw, +PH3øx6	QHN-230x6U3
* 60	Takeup Reel Table Assembly	QXP-0151
60-1	Takeup Reel Table	-
60-2	Reel Table Felt	QBF-1093
60-3	Takeup Reel Table Pulley Assembly	-
60-4	Reel Pulley Friction Spring	QBC-1061
60-5	Fiber Washer 6.2x11x0.5	QBK-7003
60-6	Stop Ring E5ø	QNS-504T3
60-7	Reel Table Felt	QBF-1094
60-8	Takeup Reel Table Pulley Assembly	-
60-9	Friction Spring	QBP-1091

61	Fiber Washer 6.2x8.2x1	QBK-7014
62	Fiber Washer 6.2x8.2x0.25	QBK-7046
63	Holding Metal for Reel Table Bearing	QMH-1046
64	Screw, +PH3øx4	QHN-230x4U3
65	Reel Table Shaft Retainer	QMM-1020
66	Backtension Washer	QBJ-3015
67	Fiber Washer 6.2x8.2x1	QBK-7014
68	Backtension Spring	QBC-1064
69	Stop Ring E5ø	QNS-504T3
70	Speed Selector Lever Assembly	QXL-0113
70-1	Speed Selector Shaft Angle Assembly	-
70-2	Speed Selector Lever	QML-1286
70-3	Stop Ring E5ø	QNS-504T3
70-4	Speed Selector Clicker Spring	QBP-1092
70-5	Thrust Steel Ball	QBK-1003
71	Stop Ring E3ø	QNS-304T3
72	Fiber Washer 4.2x6x0.5	QBK-7075
73	Washer for Tension Pulley	QWQ-1023
74	Washer 4x11x0.5	QBJ-1185
* 75	Rewind Pulley	QDP-1124
76	Fiber Washer 4.2x9x0.25	QBK-7007
77	Rewind Lever Assembly	QXL-0112
78	-	-
* 79	Stop Ring E5ø	QNS-504T3
80	Motor Pulley	QDP-1141
(appropriate)	Motor Pulley	QDP-1142
"	Motor Pulley	QDP-1143
81	Screw, 4øx6	QHP-840x6U3
82	Flywheel Idler Assembly	QXI-0014
82-1	Stop Ring E3ø	QNS-304T3
82-2	Fiber Washer 4.2x6x0.5	QBK-7075
82-3	Washer for Tension Pulley	QWQ-1023
82-4	Felt 4x11x2	QBF-1049
* 82-5	Idler	QDP-1123
82-6	Round Paper for Idler	QBF-1095
82-7	Fiber Washer 4.2x9x0.25	QBK-7007
82-8	Flywheel Idler Lever Assembly	-
* 83	Idler Arm Spring-A	QBT-1191

* 84	Idler Arm Spring-B	QBT-1189
85	Screw, +PH3 ϕ ×6	QHN-230×6U3
86	Spring Washer SW3 ϕ	QWS-302U3
87	Idler Stopper	QMA-1127
88	Screw, +PH4 ϕ ×8	QHN-240×8U3
89	Spring Washer SW4 ϕ	QWS-402U3
90	Left Brake Assembly	QUV-1018
90-1	Screw, -PH3 ϕ ×25	QHN-130×25U3
90-2	Washer for Brake Roller	QWQ-1078
* 90-3	Brake rubber	QBG-1101
90-4	Left Brake Lever Assembly	-
90-5	Washer for Spring	QWQ-1070
90-6	Spring for Brake Rubber Roller	-
90-7	Hexagonal Nut N3 ϕ	QNN-3022U3
91	Stop ring E5 ϕ	QNS-504T3
* 92	Brake Spring	QBC-1058
93	Brake Rod-A	QMR-1057
* 94	Brake Rod Spring	QBT-1192
95	Brake Rod-B	QMR-1058
96	Right Brake Assembly	QUV-1017
96-1	Right Brake Lever Assembly	-
97	Takeup Idler Assembly	QXI-0013
97-1	Stop Ring E3 ϕ	QNS-304T3
97-2	Fiber Washer 4.2×6×0.5	QBK-7075
97-3	Washer for Tension Pulley	QWQ-1023
97-4	Felt 4×11×2	QBF-1049
* 97-5	Idler	QDP-1123
97-6	Round Paper for Idler	QBF-1095
97-7	Fiber Washer 4.2×9×0.25	QBK-7007
97-8	Takeup Idler Lever Assembly	-
97-9	Fiber washer 6.2×8.2×0.25	QBJ-3036
97-10	Stop Ring E5 ϕ	QNS-504T3
97-11	Takeup Idler Arm Assembly	-
98	Stop ring E5 ϕ	QNS-504T3
99	Takeup Idler Arm Spring	QBC-1059
100	FF Lever Spring	QBC-1060
* 101	-	-
* 102	FF Lever	QML-1275

103	Stop Lever Assembly	QXL-0109
104	Stop Lever Spring	QBT-1184
※ 105	Function Cam Assembly	QXH-0012
106	Stop Ring E5φ	QNS-504T3
107	Rewind Lever Assembly	QXL-0111
108	Lock Arm	QML-1285
109	Stop Ring E5φ	QNS-504T3
110	Fiber Washer 6.2×11×0.25	QBK-7056
111	Recording Lock Plate	QMF-1147
※ 112	Recording Lock Spring	QBT-1190
113	Stop Ring E4φ	QNS-404T3
114	Click Roller	QDP-1126
115	Pressure Roller Assembly	-
※ 116	Pressure Roller Spring	QXJ-0026
117	Spring Washer SW4φ	QWS-402U3
118	Hexagonal Nut N4φ	QNN-4022U3
119	Pressure Roller Shaft	QMS-1222
※ 120	Flywheel Assembly	QXF-0029
120-1	Round Paper for Flywheel	QBF-1096
※ 121	Thrust Steel Ball	QDK-1003
122	Thrust Steel Ball Retainer	QMQ-1004-1
123	Fiber Washer 8.2×12×0.5	QBK-7049
124	Stop Ring E5φ	QNS-504T3
125	Fiber Washer 6.2×11×0.5	QBK-7003
126	Clicker Arm	QML-1273
127	Click Roller	QDP-1125
128	Click Spring	QXJ-0027
129	Base Plate Pole-A	QMP-1098
130	Base Plate Pole-B	QMP-1099
131	Stop Ring E6φ	QNS-604T3
132	Screw, +M3φ×5	QHM-230×5U3
133	Spring Washer SW3φ	QWS-302U3
134	Stop Switch Angle	QMA-1154
135	Spring Washer SW4φ	QWS-402U3
136	Hexagonal Nut N4φ	QNN-4022U3
137	Panel Pole (L-B)	QMA-1135
138	Panel Pole (L-F)	QMA-1133
139	Panel Pole (R-B)	QMA-1134

140	Panel Pole (R-F)	QMA-1132
141	Tapping Screw +3 ϕ ×8	QHB-530×8U3
142	Base Plate Assembly	-
143	Record Lock Arm Assembly	QXA-0043
144	Idler Off Arm Assembly	QXA-0044
144-1	Idler Off Arm	-
144-2	Idler Off roller	QDP-1127
144-3	Stop Ring E4 ϕ	QNS-404T3
145	Fiber Washer 6.2×11×0.5	QBK-7003
146	Stop Ring E5 ϕ	QNS-504T3
147	Idler Off Rod	QMR-1059
148	Idler Off Rod Spring	QBT-1203
149	Record Lock Spring	QBC-1063
* 150	Sub Cam Plate Assembly	QXH-0013
151	Screw, -PH3 ϕ ×8	QHN-130×8U3
152	Rewind Arm	QML-1280
153	Rewind Arm Spring	QBC-1057
154	Stop Ring E3 ϕ	QNS-304T3
155	Motor Base Plate Assembly	QXK-1060
155-1	Motor Base Plate	QMK-1075
* 155-2	Motor Cushion Rubber	QBG-1086
156	Felt	QBF-1065
157	Screw, +PH4 ϕ ×8	QHN-240×8U3
158	Spring Washer SW4 ϕ	QWS-402U3
* 159	Motor	4P-17A
160	Motor Rubber Retainer	-
* 161	Motor Holding Screw	QHQ-1066
162	Equalizer Switch Lever	QML-1287
163	Fiber Washer 6.2×11×0.25	QBK-7056
164	Stop Ring E5 ϕ	QNS-504T3

CABINET PARTS

* 251	Case Lid Assembly	-
* 252	Panel Assembly	-
252-1	Opening and Closing Parts	QBJ-1169
252-2	Holding Plate	QKT-1192
252-3	Shutter Spring	QBT-1204
252-4	Rubber Spacer	QBG-1063

※ 253	Case Body Assembly	-
※ 253-1	Handle	QKH-1036
※ 253-2	Handle Metal	QKT-1188
253-3	Rubber Foot	QKA-1043
253-4	Rubber for Speaker Hold	QBG-1107
253-5	Handle Washer	QBJ-3041
※ 254	Function Knob	QGT-2023A
255	Small Screw	QHQ-1004
※ 256	Knob	QGT-1059
※ 257	Mount Assembly	-
※ 258	Speed Selector Knob	QGT-2113
259	Screw, +PH4 ϕ ×14	QHN-240×14 CL1
260	Screw, +PH4 ϕ ×20	QHN-240×20 CL1
261	Screw, +M3 ϕ ×16	QHM-230×16 U3
262	Screw, +PH3 ϕ ×14	QHN-230×14 V1
※ 263	Rubber Foot	QKA-1042
※ 264	Record Button	QGO-1031
265	Plastic Washer	QBJ-1172

ACCESSORIES

※ 281	Dynamic Microphone	WM-2057P
※ 282	Microphone Stand	WN-115P
※ 283	7" Recording Tape	QFT-71PZ
※ 284	7" Empty Reel	QFR-71PZ
※ 285	Radio Cord-R	QEB-17
※ 286	Connection Cord-B	QEB-18
※ 287	Splicing Tape	QFS-2-1
※ 288	Reel Holder	QBG-1030-1
※ 289	Instruction Book	QQT-1006

PACKING

301	Packing Case	QPN-1424
302	Inner Cushion (Left)	QPN-1425
303	Inner Cushion (Right)	QPN-1426
304	Pad	QPN-1450
305	Reel Case	QPN-1451
306	Gauze	QPQ-1015
307	Number Plate	QPN-1054

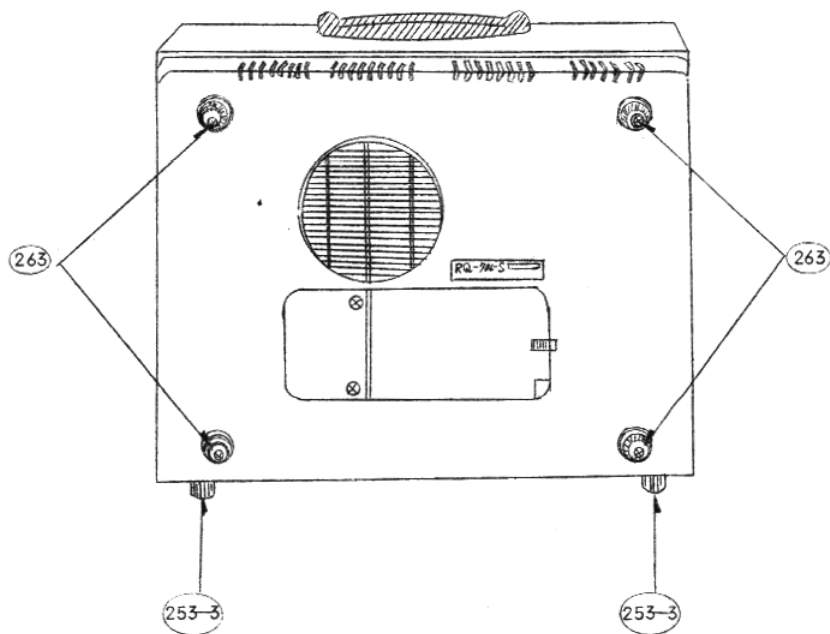
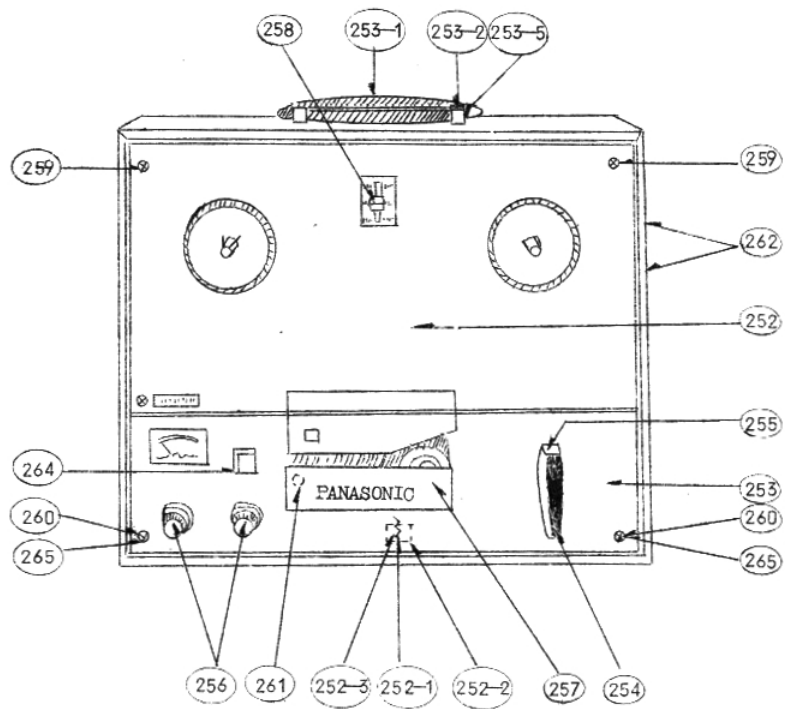

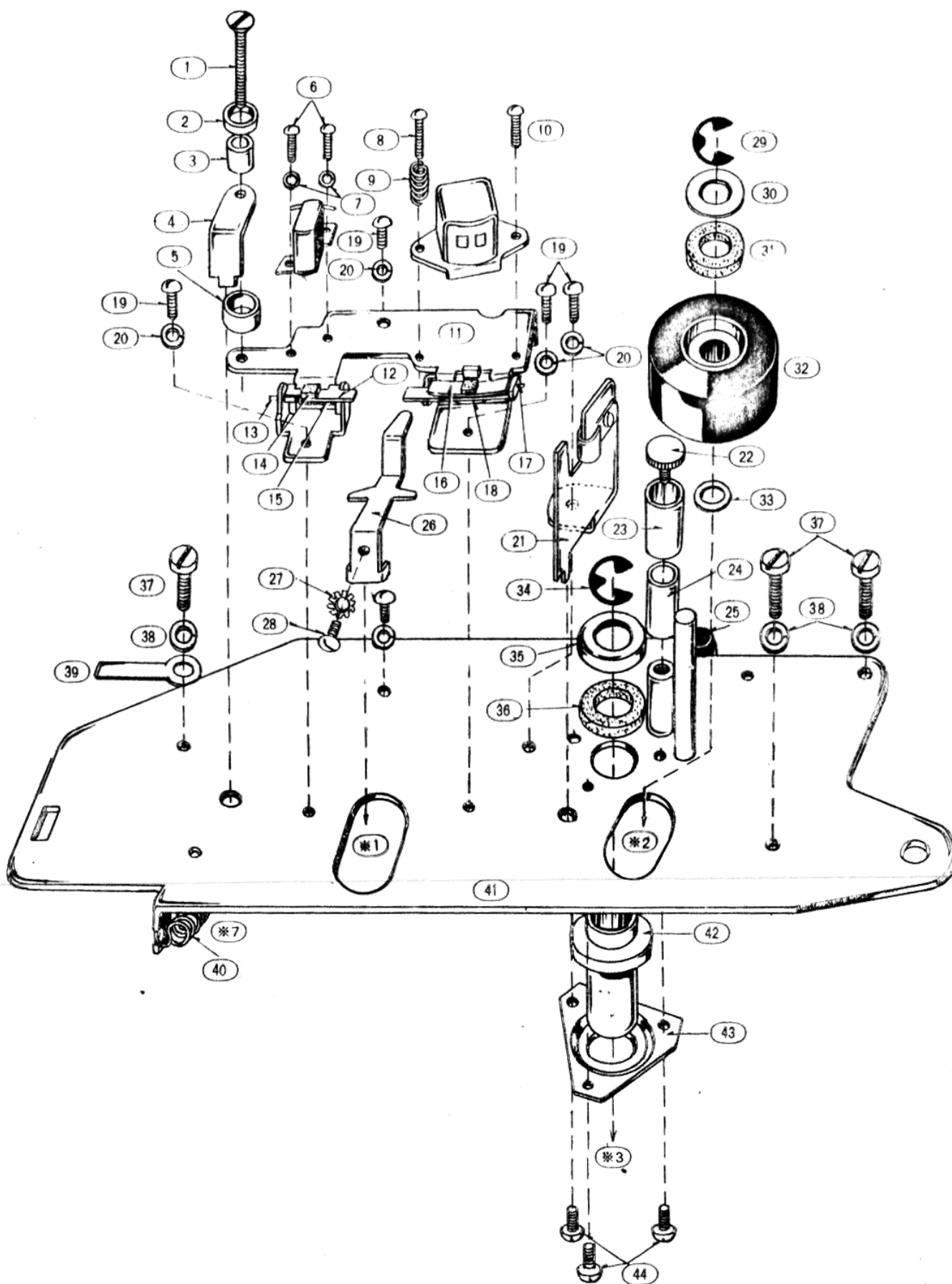

- 1
- 6
- 2
- 8
- 3
- 9
- 7
- 4
- 5
- 10
- 29
- 30
- 3'
- 20
- 31
- 11
- 12
- 32
- 13
- 14
- 17
- 16
- 18
- 15
- 22
- 26
- 23
- 21
- 24
- 27
- 25
- 28
- 33
- 37
- 34
- 38
- 35
- 39
- 36
- *1
- *2
- *7
- *3
- 41
- 42
- 40
- 43
- 44

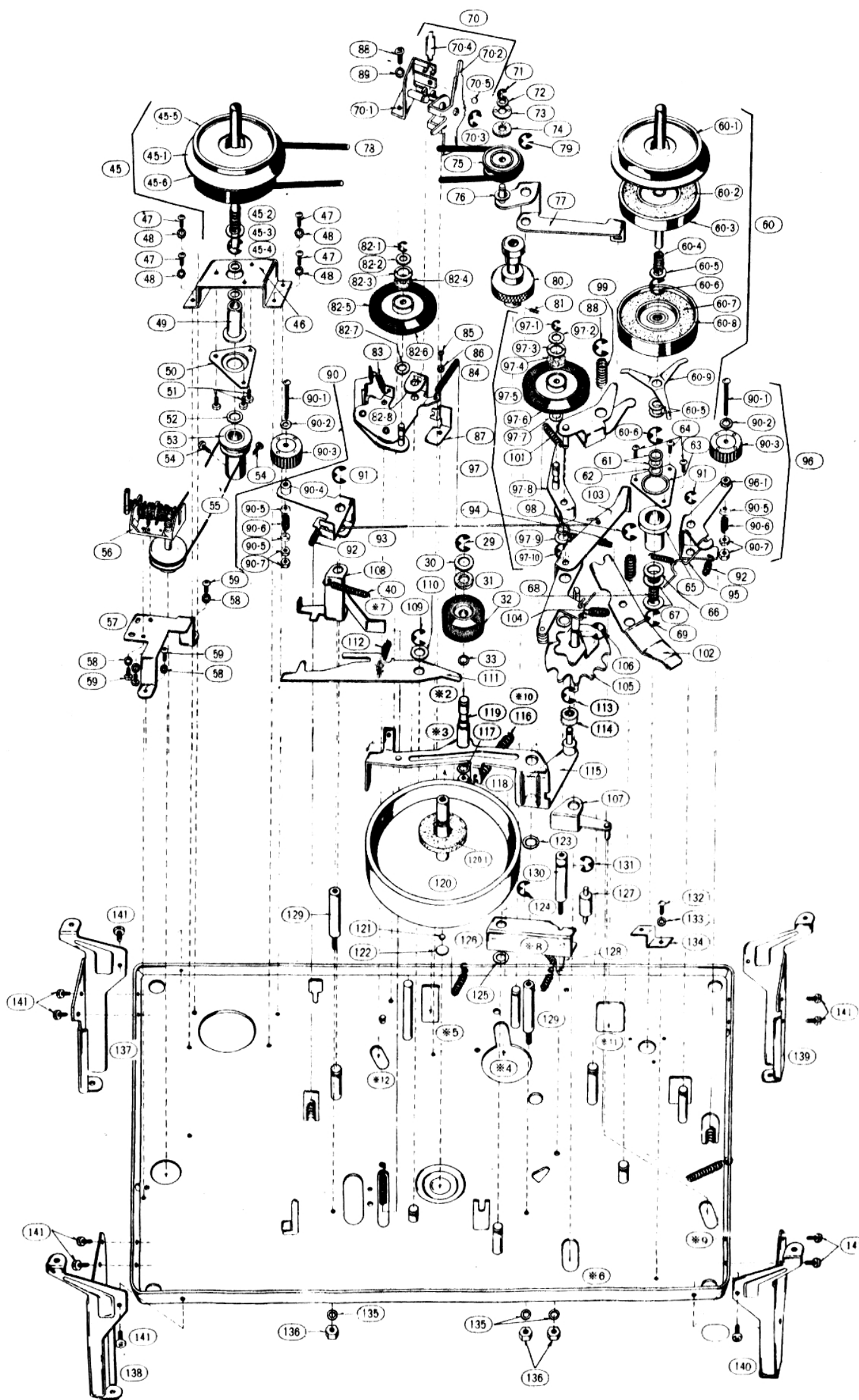

- | | |
|------|------|
| 70 | 70 |
| 70-4 | 88 |
| 70-2 | 89 |
| 71 | 71 |
| 70-5 | 70-5 |
| 45-5 | 72 |
| 73 | 73 |
| 45-1 | 70-1 |
| 45-6 | 60-1 |
| 45 | 60 |
| 45-2 | 74 |
| 47 | 70-3 |
| 48 | 78 |
| 45-3 | 75 |
| 48 | 60-2 |
| 45-4 | 76 |
| 49 | 77 |
| 46 | 60-3 |
| 50 | 60-4 |
| 51 | 60-5 |
| 52 | 60-6 |
| 53 | 60-7 |
| 54 | 60-8 |
| 55 | 60-9 |
| 56 | 60-5 |
| 57 | 60-6 |
| 58 | 60-7 |
| 59 | 60-8 |
| 60 | 60-9 |
| 61 | 60-5 |
| 62 | 60-6 |
| 63 | 60-7 |
| 64 | 60-8 |
| 65 | 60-9 |
| 66 | 60-5 |
| 67 | 60-6 |
| 68 | 60-7 |
| 69 | 60-8 |
| 70 | 60-9 |
| 71 | 60-5 |
| 72 | 60-6 |
| 73 | 60-7 |
| 74 | 60-8 |
| 75 | 60-9 |
| 76 | 60-5 |
| 77 | 60-6 |
| 78 | 60-7 |
| 79 | 60-8 |
| 80 | 60-9 |
| 81 | 60-5 |
| 82 | 60-6 |
| 83 | 60-7 |
| 84 | 60-8 |
| 85 | 60-9 |
| 86 | 60-5 |
| 87 | 60-6 |
| 88 | 60-7 |
| 89 | 60-8 |
| 90 | 60-9 |
| 91 | 60-5 |
| 92 | 60-6 |
| 93 | 60-7 |
| 94 | 60-8 |
| 95 | 60-9 |
| 96 | 60-5 |
| 97 | 60-6 |
| 98 | 60-7 |
| 99 | 60-8 |
| 100 | 60-9 |
| 101 | 60-5 |
| 102 | 60-6 |
| 103 | 60-7 |
| 104 | 60-8 |
| 105 | 60-9 |
| 106 | 60-5 |
| 107 | 60-6 |
| 108 | 60-7 |
| 109 | 60-8 |
| 110 | 60-9 |
| 111 | 60-5 |
| 112 | 60-6 |
| 113 | 60-7 |
| 114 | 60-8 |
| 115 | 60-9 |
| 116 | 60-5 |
| 117 | 60-6 |
| 118 | 60-7 |
| 119 | 60-8 |
| 120 | 60-9 |
| 121 | 60-5 |
| 122 | 60-6 |
| 123 | 60-7 |
| 124 | 60-8 |
| 125 | 60-9 |
| 126 | 60-5 |
| 127 | 60-6 |
| 128 | 60-7 |
| 129 | 60-8 |
| 130 | 60-9 |
| 131 | 60-5 |
| 132 | 60-6 |
| 133 | 60-7 |
| 134 | 60-8 |
| 135 | 60-9 |
| 136 | 60-5 |
| 137 | 60-6 |
| 138 | 60-7 |
| 139 | 60-8 |
| 140 | 60-9 |
| 141 | 60-5 |

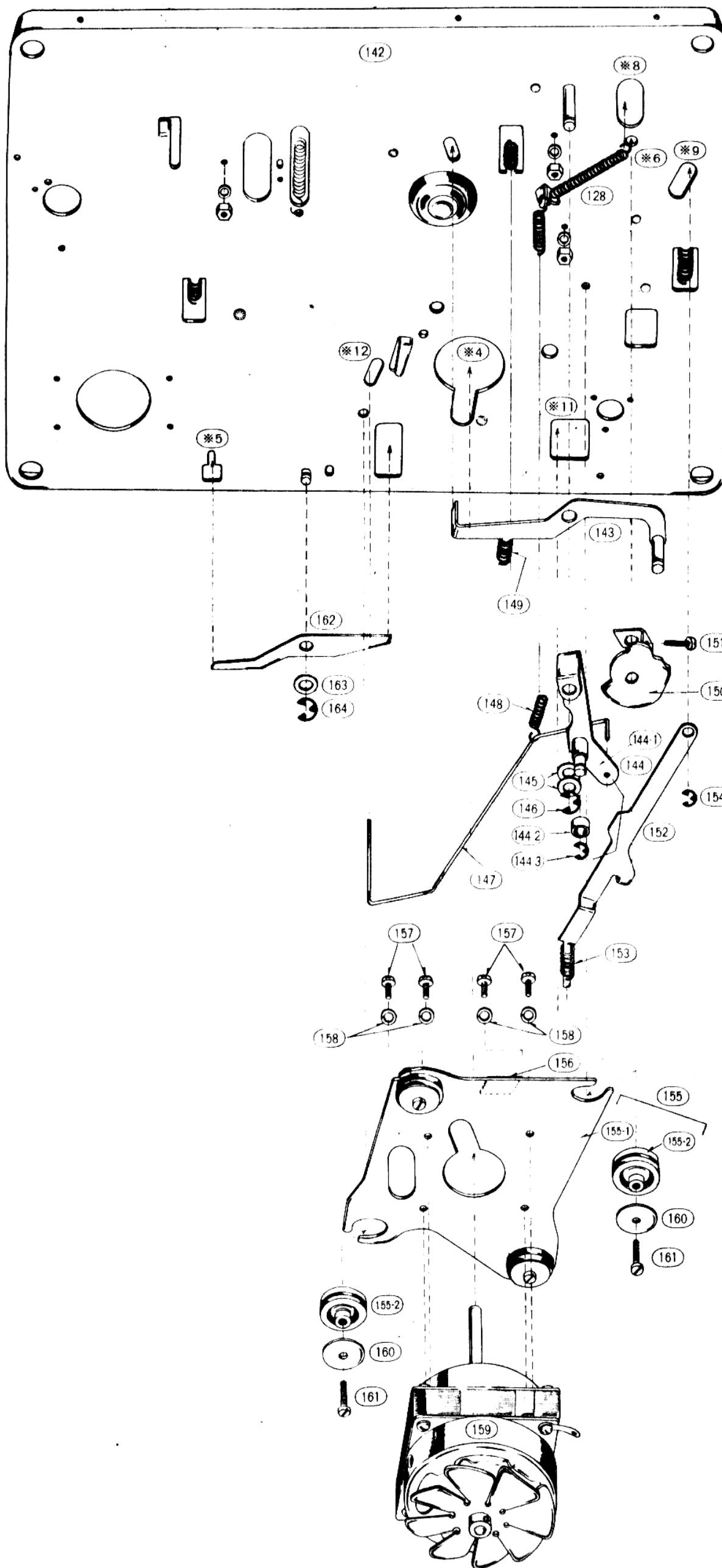

- (142)
- ※8
- ※6
- ※9
- (128)
- ※4
- ※12
- ※11
- ※5
- (143)
- (149)
- (162)
- (151)
- (148)
- (150)
- (163)
- (144-1)
- (164)
- (144)
- (145)
- (154)
- (146)
- (144-2)
- (152)
- (44-3)
- (147)
- (157)
- (153)
- (158)
- (156)
- (155)
- (155-1)
- (155-2)
- (160)
- (161)
- (159)

SCHEMATIC CIRCUIT DIAGRAM

